



INSTALLATION INSTRUCTIONS

These installation instructions are for use with HTS Self-Regulating Heating Products: LXR, MXR and HXR Series. This kit may be installed in temperatures as low as - 40°F (-40°C).

For technical support call HTS.

WARNINGS

This is an electrical device and in order to ensure proper operation and prevent shock or fire it must be installed correctly. Read these important warnings. Follow all installation instructions.

CAUTION

Ground-fault equipment protection shall be provided to de-energize all normally ungrounded conductors of electrical heating cable sets, with ground fault settings sufficient to allow normal operation of the heater unless applicable codes permit otherwise, and to minimize the danger of fire from sustained electrical arcing if the heating cable is damaged or improperly installed and to comply with HTS requirements, agency certifications and national electrical codes. Conventional circuit breakers may not stop arcing. Each heating device branch circuit or each heating device shall have ground fault equipment protection. Metallic structures or materials such as metal pipes used to support the heater cable shall be grounded. Component approvals and performance characteristics are based on HTS specific parts only. Substitution will void approvals and performance claims. Component and heating cable ends must be kept dry before and during installation. Fire resistant thermal insulation should be used. Bond the metallic braid of the self-regulating heating cable to a suitable grounding (earth) terminal. De-energize before installation or servicing.



WARNING

EXPLOSION HAZARD - DO NOT DISCONNECT EQUIPMENT UNLESS POWER HAS BEEN SWITCHED OFF OR THE AREA IS KNOWN TO BE NON- HAZARDOUS. AVERTISSEMENT - RISQUE D'EXPLOSION - AVANT DE DECONNECTER L'EQUIPEMENT, COUPER LE COURANT OU S'ASSURER QUE L'EMPLACEMENT EST DESIGNE NON DANGEREUX.

For use with HTS Heating Cables only

CAUTION: A ground fault protection device must be used with this heating device.

Cable – Specific Specifications PGW/MT Only: 3-10 W/ft., Maximum 32A. 120-240V Maximum continuous exposure temperature 150°F/65°C. Min. bend radius: 1.18 in. (30 mm) @ 68°F/20°C.

APPROVALS



Class I, Div. 2, Groups A, B, C, D

Class II, Div. 2, Groups F, G

Class III

KIT CONTENTS

Qty	Description
1	Stanchion c/w Silicone Grommet, cable Guide, connector, O-rings,
1	Strain relief washer
1	Cap light assembly
1	Pipe clamp
2	Crimp splices

MATERIALS NEEDED

Knife, Multi Head Screwdriver, channel locks, glass fiber tape.

INSTALLATION INSTRUCTIONS

1. Cut cable at an angle to pierce grommet. Allow 3" (75mm) for light assembly and 12" (305mm) for service loop.

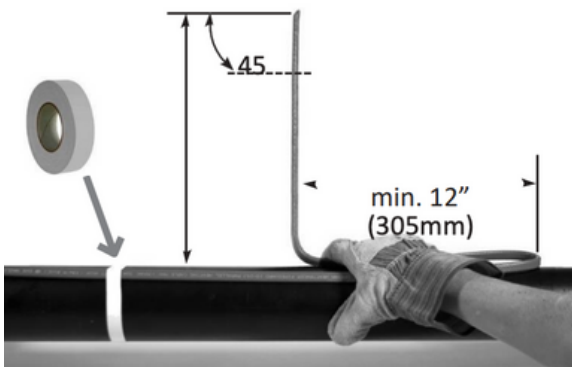

2. Push the cable up through the pipe stanchion piercing the grommet.

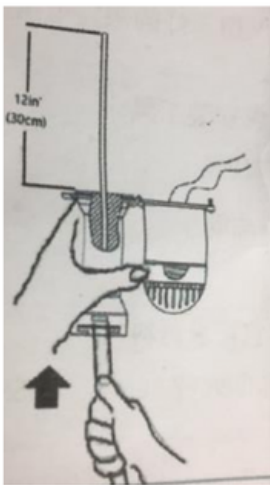

3. Attach stanchion with pipe clamp. Do not tighten pipe clamp over cable.

4. Prepare the cable end by removing the outer jacket and ground braid. Ensure a minimum of 2.25 inches (57 mm) remains for cable connection

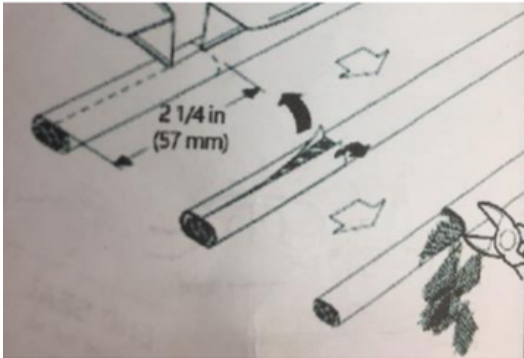

5. Remove the inner jacket, and heating core exposing bus wires.

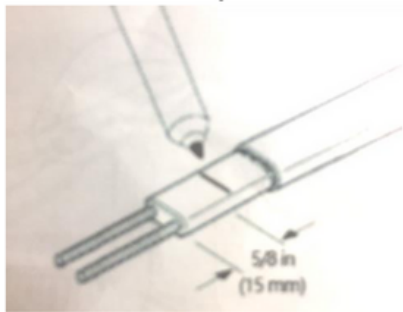

6. Trim the bus wires to a length of 1/2 inch (13mm). Connect the heating cable bus wires to the leads on the lighted assembly by way of supplied crimp connectors. Secure the Lighted lid to the stanchion.

